

Sheet No. 14 – Isometric Projections

1. Draw the Isometric projection of the following,

a) A front view of a plane, which is circle of radius 25 mm.

b) Semicircular block resting on rectangular face with radius 30 mm and thickness 9 mm.

c) Frustum of pyramid with 30mm hexagon at base, and 15 mm hexagon at 50 mm height.

2. Draw the Isometric projection of the following figures:

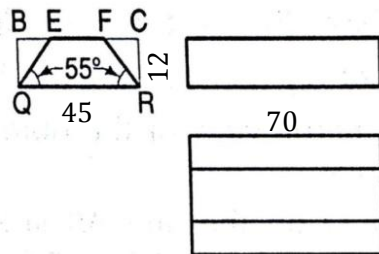

Figure a

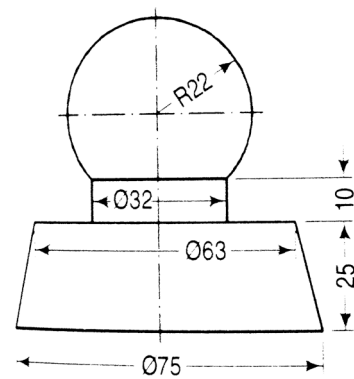

Figure b

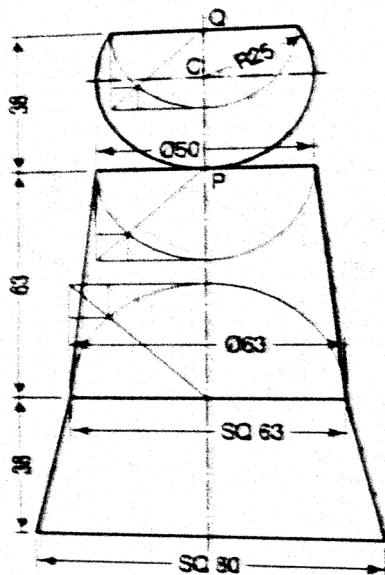

Figure c

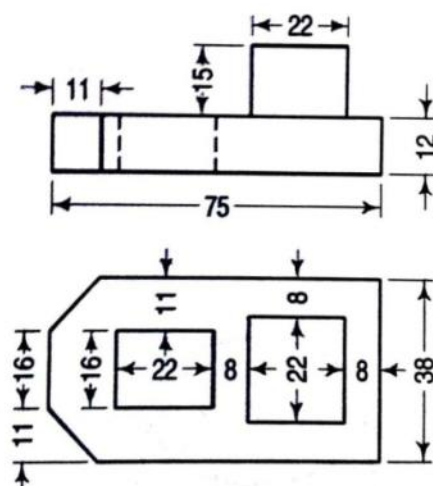

Figure d